

Owner's Manual

You have purchased a Jetson surfboard.

Its use is very intuitive but, nevertheless, **YOU MUST READ AND FAMILIARIZE YOURSELF WITH THE SAFETY INSTRUCTIONS** to ensure its correct use. It's also good to learn a few details that will allow you to unleash your Jetson's full potential.

Jetson
Surf Technology

Jetson is not a recreational boat. It's not a toy you can take to the beach. It's not a jet-ski to go over the waves head on and jump over them. It's a surfboard and you have to find the channel and the gap between sets to go out. Correct use increases battery life. Our advice to you: paddle, do some exercise, help the jet with your arms and use it only when you need an extra boost.

Full System:

- Jetson Li-Ion Electric Powered E-Board
- Basic Operating Tools
- Lithium-Ion Battery Pack
- Lithium-Ion Charger
- Owner's Manual

- **DO NOT USE THE BOARD WITHOUT A LEASH, THE JET MAY TAKE IT VERY FAR.**
- **EXCLUSIVELY FOR ADULT USE. UNDER NO CIRCUMSTANCE SHOULD YOU LET PEOPLE UNDERAGE USE IT.**
- **READ THE ENTIRE OWNER'S MANUAL BEFORE USE.**

Instructions for Use

General Considerations

Jetson is intuitive and easy to use; it has been designed so that all you have to worry about is surfing but, even so, it features several components that traditional boards don't have and you must know them in order to make the most of them.

Connecting & Disconnecting

Jetson boards don't have an on/off switch. For that purpose, you need to connect/disconnect the batteries. It's been designed this way to ensure batteries are taken out after use.

Battery Life

When you use a Jetson, you must always bear in mind you are using batteries and, given the power output on key moments, if we manage battery use carefully they will have a longer life, we'll be able to stay longer in the water and we'll catch more waves. The board is not designed to avoid paddling all together or to keep the jet on constantly. When surfing, there are many wait and position-taking times.

Sun Exposure

Avoid exposure to excessive heat or sun. High temperatures damage the board. Never leave the board inside a car in a hot day. Excessive temperature can make some board components bend or twist or alter the characteristics of certain materials.

Rinse Board

After surfing with your Jetson, be sure to rinse the board with fresh water, paying special attention to the propulsion tube to prevent any rust / corrosion.

Button Controls Panel

Power Controls

Button controls are integrated on a panel located on the board's nose for jet power output control. There are 5 buttons – a stop button and 4 others for different power levels adapted to the circumstances.

WARNING! NEVER START THE JET OUTSIDE THE WATER

A long dry start (more than 1-3 seconds) could damage the jet's watertight seals.

100% Boost for Take Off. It provides maximum propulsion and it is only used to ensure you drop in and ride the wave. It uses up a lot of battery power, which is why it is highly recommended to use it only to catch waves, which takes just a few seconds.

75% Breaking Zone. It is used to go past the breaking waves by providing a powerful boost to punch through this zone. Because battery consumption is high on this mode, it must only be used when we have to leave the breaking zone as quickly as possible.

50% paddle out. To paddle out to the lineup and maintain position while waiting for sets.

25% Eco Mode. It provides a gentle but noticeable boost to move slowly, saving battery energy. It allows you to move back and forth between wave peaks in an area with no breakers. If conditions are not rough or waves aren't breaking, this speed is enough.

X Power. It stops the engine when we want to paddle manually or wait for waves when there is no current.

Stop timers: Jet usage is meant to be intermittent. To help achieve this, the boards incorporate a timer that stops the engine and leaves it on standby if the button controls are idle for over two minutes. If it has been stopped and left on standby, it can be activated by pressing any button.

LED Indicators

There are three LED indicators located on the upper section of the controls. They provide information about the equipment's function status.



Temperature. If there is overheating in the engine compartment due to engine overuse on high power, this indicator lights up and the engine stops. When the motor cools down, the indicator goes off and the board can be turned back on.



Propeller Obstruction. The propeller is protected with a grid to keep objects from drifting in and obstructing the jet. Both the design and distances have been optimized to avoid this problem. However, it is impossible to rule this out completely, which is why if the controls panel detects a foreign body this indicator will light up. If the obstruction is very serious the system switches off completely. The surfer must check whether there are any unwanted objects in the jet.



Battery Status. It can show 3 colors. Green when the battery is OK. Yellow when battery levels are below **50%** of its total capacity. And red when batteries are at **20%** capacity. When batteries reach 0% the engine stops, and it cannot be turned back on.

Battery Pack

- **NEVER LEAVE BATTERY PACKS DIRECTLY EXPOSED TO THE SUN.**
- **NEVER LEAVE BATTERIES CONNECTED IN THE BOARD WHEN NOT IN USE.**

Battery Pack Precautions

- Do not wet the battery pack. Wetting the battery pack will void your warranty.
- Never leave battery packs connected inside the board when not in use.
- Never leave battery packs directly exposed to the sun.
- Do not expose battery packs to fire.
- Keep battery terminals clean.

Instructions for battery recharge

1. Plug designated Jetson charger into the wall.
2. Connect battery to charger with the power connector.
3. LED power light indicate that charge has started.
4. While charging with the **2.8 Amp(A)** charger, LED lights will show the percentage 20% 50% 80% 100%
While charging with the **7A** charger, the charging LED will light up red.
5. The **2.8A** charger takes 3-5 hours for a full charge.
The **7A** charger takes 2-4 hours for a full charge.
6. To maintain battery strength, you must recharge battery packs every 60 days if they are not used.

Instructions for battery cover closure

Removable batteries are the best solution to enjoy a good day of surf without making the board too heavy. ON THE FLIP SIDE, USING THEM MAKES THE USER RESPONSIBLE FOR THE CORRECT CLOSURE OF THE BATTERY CASE. READ THIS BEFORE CLOSING THE CASE.

VERY IMPORTANT: Read these instructions carefully before closing the battery cover. Close cover slowly, take a few seconds to ensure you maximize battery life.

1. Check that there is no sand in the battery compartment screw holes to ensure a water-tight seal to prevent damage to your battery pack.
2. Insert charged batteries in the case located in the board and connect them. (Diagram 1).
3. Place cover correctly.
4. Screw bolts in only half-way. (Diagram 2).
5. Once all 4 bolts are in place, tighten them all the way but not too much, just so that the
6. bolts' head is at a level with the cover.
7. Once the bolts are inside the cover but not too tightly screwed on, start tightening them
8. one turn of each bolt at a time, following a criss cross pattern. Screw on until they are firmly secured. DO NOT OVERTIGHTEN BEYOND THIS POINT. Over-tightening can damage the board permanently.
9. Verification: We know it is secured when the four corners are at the same height and level with the board. (Diagram 3).

- **NEVER LEAVE THE COVER SECURED ON (FIRMLY TIGHTENED) FOR LONG PERIODS OF TIME DURING STORAGE OR TRAVEL. THIS WILL PRESERVE YOUR O-RING SEAL.**

1

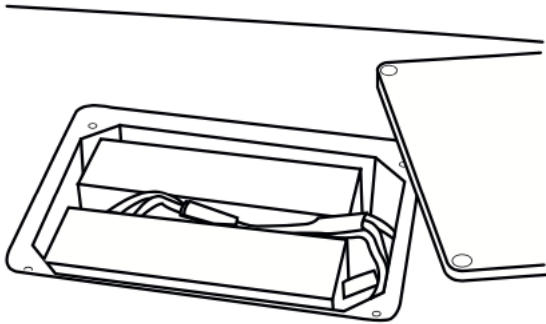

2

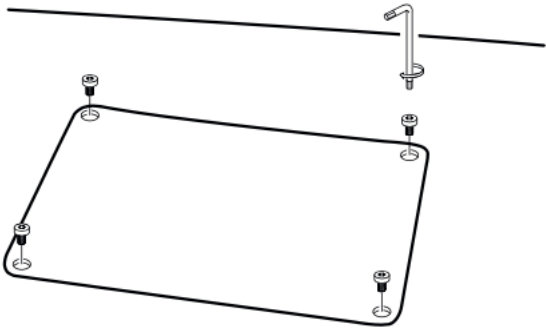

3

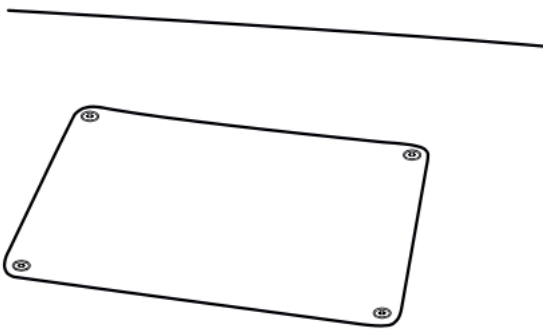

Propeller blockage. Dismantling the grid and the nozzle.

The jet includes a grid to minimize risk of foreign bodies that can block the propeller entering the jet. Nevertheless, sometimes an object may block the propeller. In waters with many floating objects that could potentially enter the propeller, it's advisable to minimize jet use. However, in case there's a total obstruction and the propeller gets blocked, Jetson includes ultrafast protection by disconnecting the whole system to avoid greater damage. You will know that protection has been operated automatically because all the LED lights on the button controls will switch off and it will not work anymore.

There could also be a partial obstruction that can be detected by a change in the jet sound or the fact that it seems to have lost power. The LED with the propeller icon will light up.

In any of the above cases, you must check the jet and remove any foreign object but, be careful! IT IS MANDATORY TO DISCONNECT THE BATTERY in order to perform any operation involving jet handling.

1. Make sure the battery is DISCONNECTED to avoid untimely starting of the propeller during handling without the grid.
2. Unscrew the grid's bolts. (Diagram 4).
3. Remove the grid. (Diagram 5).
4. Remove object that is blocking the propeller. (Diagram 6).
5. Put the grid back on (in the correct position) and tighten the bolts.
6. If necessary, remove nozzle to gain access to obstructing object.
7. Unscrew the nozzle's 4 bolts. (Diagram 7).
8. Remove nozzle by pulling with your fingers towards the stern. If it's tight, turn it clockwise. In case of having to use a metallic tool, NEVER LEAVE THE NOZZLE in direct contact with it. It could damage it or reduce propelling power. (Diagram 8) Protect from tool with a rag.
9. Now you can remove the object.
10. Before replacing the nozzle, gently tap on it with a nylon or rubber hammer or place a softer material between tool and nozzle (Diagram 9). Never apply an iron hammer directly (Diagram 10), the propeller must be facing the stern to ensure it has reached its furthest position.
11. Place the nozzle correctly and screw on the bolts until nozzle meets jet.
12. Reconnect battery. In case of total blockage, the system reboots.

Run a dry test to check if the jet turns and sounds correctly.

WARNING! DRY TEST RUNS MUST NEVER LAST LONGER THAN 1-3 SECONDS OR ELSE THE PROPELLER'S SEALS WILL BURN.

4

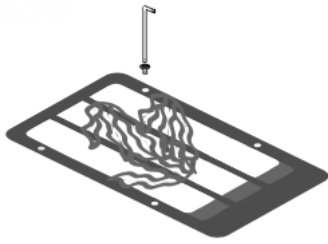

5

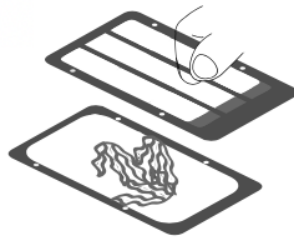

6

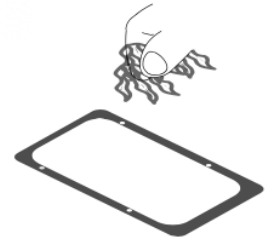

7

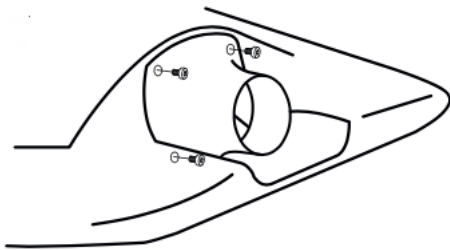

8

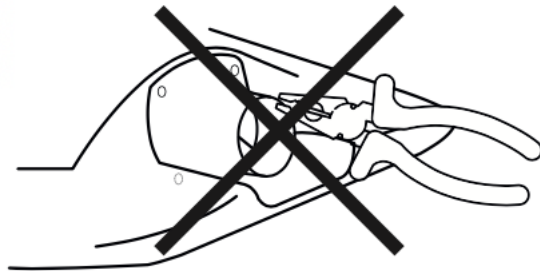

9

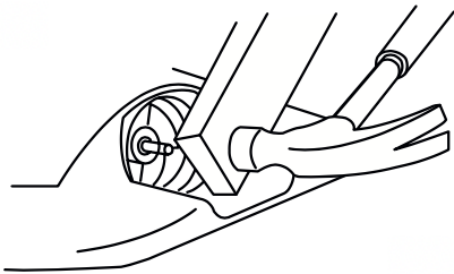

10

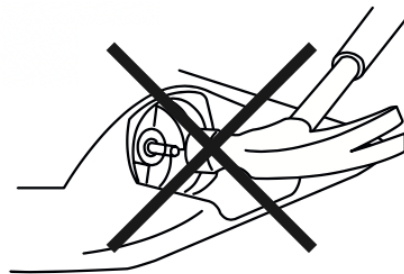

For further information, questions,
comments or any kind of query, please
contact our technical support service.

321-313-8059

JetsonUSA@gmail.com

www.JetsonSurfTechnology.com

Jetson
Surf Technology